

There is something special about Setia Alam. Once a quiet pocket of Shah Alam, it has flourished into one of Klang Valley's most liveable townships where families thrive, entrepreneurs dream big and communities stay closely connected.

This well-planned, green-focused community is one of Klang Valley's fastest-growing neighbourhoods, surrounded by established residences, schools, retail outlets and lifestyle hubs.

Now, this vibrant suburb welcomes its next highlight with the unveiling of KSL Blossom Square by KSL Holdings Bhd, featuring a mix of shoplots and serviced apartments.

Strategically located on 18 acres of freehold land, KSL Blossom Square, with a gross development value (GDV) of RM500mil, is more than just another project. It is envisioned as a thriving destination that blends wellness, connectivity and contemporary design, offering both stylish homes and dynamic commercial spaces within one integrated address.

KSL Blossom Square concept runs through the development's masterplan, creating a serene sanctuary where urban living meets the soothing touch of nature.

The project comprises 733 serviced apartments and 21 commercial shoplots carefully crafted to form a self-sustaining community. The serviced residences dubbed HAUS Residences come with four types of layouts. The most affordable and smallest option is Type A, priced at RM270,000 for 550 sq ft, featuring a one-plus-one bedroom layout and one bathroom, ideal for singles or couples.

Moving up in size, Type B offers 650 sq ft with two bedrooms and two bathrooms. The largest options are Type C and Type C1, which both provide a spacious 900 sq ft with three bedrooms and three bathrooms. This range ensures choices from compact, entry-level units to larger residences suitable for families and investors.

Each home features modern interiors, open-plan living areas and ample natural lighting, creating a sense of space and calm.

Complementing these are the three-storey shops, with built-ups from 4,502 sq ft to 16,990 sq ft. Positioned for high visibility and easy access, they are ideal for cafes,

A BLOOMING NEW LANDMARK IN SETIA ALAM

KSL Blossom Square offers stylish homes and dynamic commercial spaces within one integrated address



An artist impression of KSL Blossom Square.

clinics, lifestyle stores or established businesses seeking to tap into Setia Alam's fast-growing population. KSL Blossom Square is expected to be completed in 2028.

Together, these two components form a balanced ecosystem where convenience, lifestyle and opportunity coexist — a place where one can live upstairs, shop downstairs and unwind just steps away.

The development is thoughtfully planned with landscaped gardens, shaded walkways, walking trails, an edible garden and meditation nooks that encourage residents to unwind and reconnect with nature. For community engagement and lifestyle living, residents can enjoy spending time at the pool pavilion, multipurpose courtyard, playground, community field as well as dining and barbeque nook, among others.

One of KSL Blossom Square's biggest advantages is its location. The development is surrounded by mature amenities and supported by a strong network of highways, including New Klang Valley Expressway (NKVE), South Klang Valley Expressway (SKVE), Shah Alam Expressway (KESAS), North South Expressway Central Link (ELITE) and the Setia Alam Highway, offering direct access to Klang, Petaling Jaya, Subang and Kuala Lumpur.

For daily conveniences, Setia City Mall is right next door, placing retail, dining and entertainment options within easy reach. Families benefit from reputable schools such as Tenby International School and several national schools nearby while Hospital Shah Alam and nearby clinics ensure essential healthcare is close at hand.

Recreation is also part of the



A tranquil water feature designed to soothe the senses — The Creek brings nature's rhythm into the heart of the community.

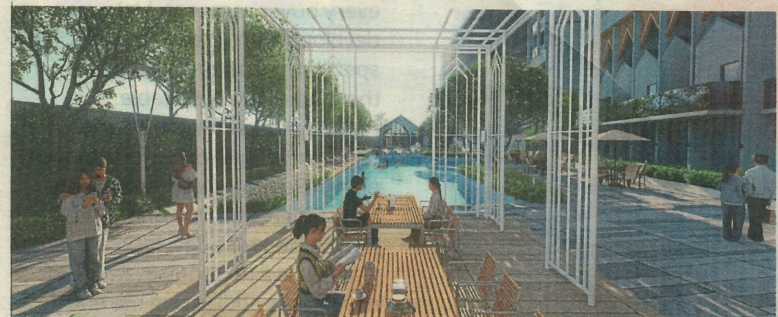

Bask in comfort and elegance — the Pool Pavilion offers a stylish retreat beside the sparkling waters of KSL Blossom Square.

lifestyle here from the township's well-known bike lanes and parks to the nearby Taman Botani Negara, a lush green escape perfect for weekend picnics and family adventures. Everything you need, from leisure to learning to lifestyle, is just around the corner.

Behind KSL Blossom Square stands a trusted developer with over three decades of experience in shaping thriving communities across Malaysia.

The company's portfolio spans major developments such as Canary Garden @ KSL Bandar Bestari and 18 Madge Onsen Suite among others — all known for their thoughtful design, strong value and sustainable growth.

Having built a solid reputation in Johor Bahru and beyond, KSL continues to expand its footprint into the Klang Valley, bringing with it a proven track record of excellence and reliability. Each project reflects KSL's philosophy: to create spaces that not only deliver value but also enrich the way people live, work and connect.

Setia Alam's growth story is

one of steady transformation from a master-planned township to a bustling address with its own commercial pulse. Against this backdrop, KSL Blossom Square stands as an attractive investment proposition.

With its freehold status, strong connectivity, the development offers solid potential for capital appreciation and long-term rental demand. Entrepreneurs will also find opportunity here, thanks to the township's expanding catchment of residents and visitors, all looking for new retail and lifestyle experiences.

In short, KSL Blossom Square isn't just about living well, it's about growing with the community and being part of Setia Alam's promising future.

As Setia Alam continues to flourish, KSL Blossom Square is set to take its place as the next vibrant hub — a destination that celebrates balance, wellness and community.

In the pipeline is the KSL Koji Business Park, a major 75-acre development in Ijok, Puncak Alam. Phase 1 comprises 54 units of three-storey semi-detached factories, each offering a spacious built-up of 6,607 sq ft. Priced from RM4mil, the project is expected to be completed in 2029.



Unwind in style — a simulation of the Leisure Nook offers a cosy corner to relax, reflect or reconnect.



Experience modern lifestyle elevated — KSL Blossom Square's thoughtfully designed facilities bring community, wellness and convenience together.